

Flat 2 Alcyone

24 Shore Road
Sandbanks, Poole
Dorset BH13 7PJ



Flat 2 Alcyone

24 Shore Road
Sandbanks, Poole
Dorset BH13 7PJ

Price Guide OIRO £850,000

Alcyone is situated in a perfect location nestled between the beach and Poole Harbour, just a stones throw from both. Being only one of four apartments within the block it makes for an ideal main residence or second home.

Summary of Accommodation

- Stunning harbour views
- 2 double bedrooms (both en-suite)
- Underground secure parking space
- Small block of four apartments
- Share of Freehold
- Moments from the beach





Nearby beach

Flat 2 Alycane is situated on the first floor.

Upon entry you are welcomed by part glazed double doors leading into the main family/kitchen/living area which offers a range of integrated appliances and a central island with stone worksurface.

The large floor to ceiling glazed turret dining area has stunning harbour views and an additional sitting area with a Juliet balcony.

The property has two double bedrooms, both with en-suites and stunning views from the main open plan kitchen/living room.

The principal bedroom benefits from an en-suite and dressing area with a Juliet balcony overlooking the rear grounds.

The second double bedroom also benefits from an en-suite. There is a separate utility room which provides extra storage and houses the gas boiler. There is a separate wc for guests.

The property has a designated underground parking space for one vehicle and two visitors' spaces, this area is accessed via electric security gates and there is further security by the way of CCTV cameras.

Behind the parking space is an additional area for a personal lockable storage unit if required. The block is serviced by a lift that gives access to all floors including the underground car park.

Approximate Area = 122.1 sq m / 1315 sq ft

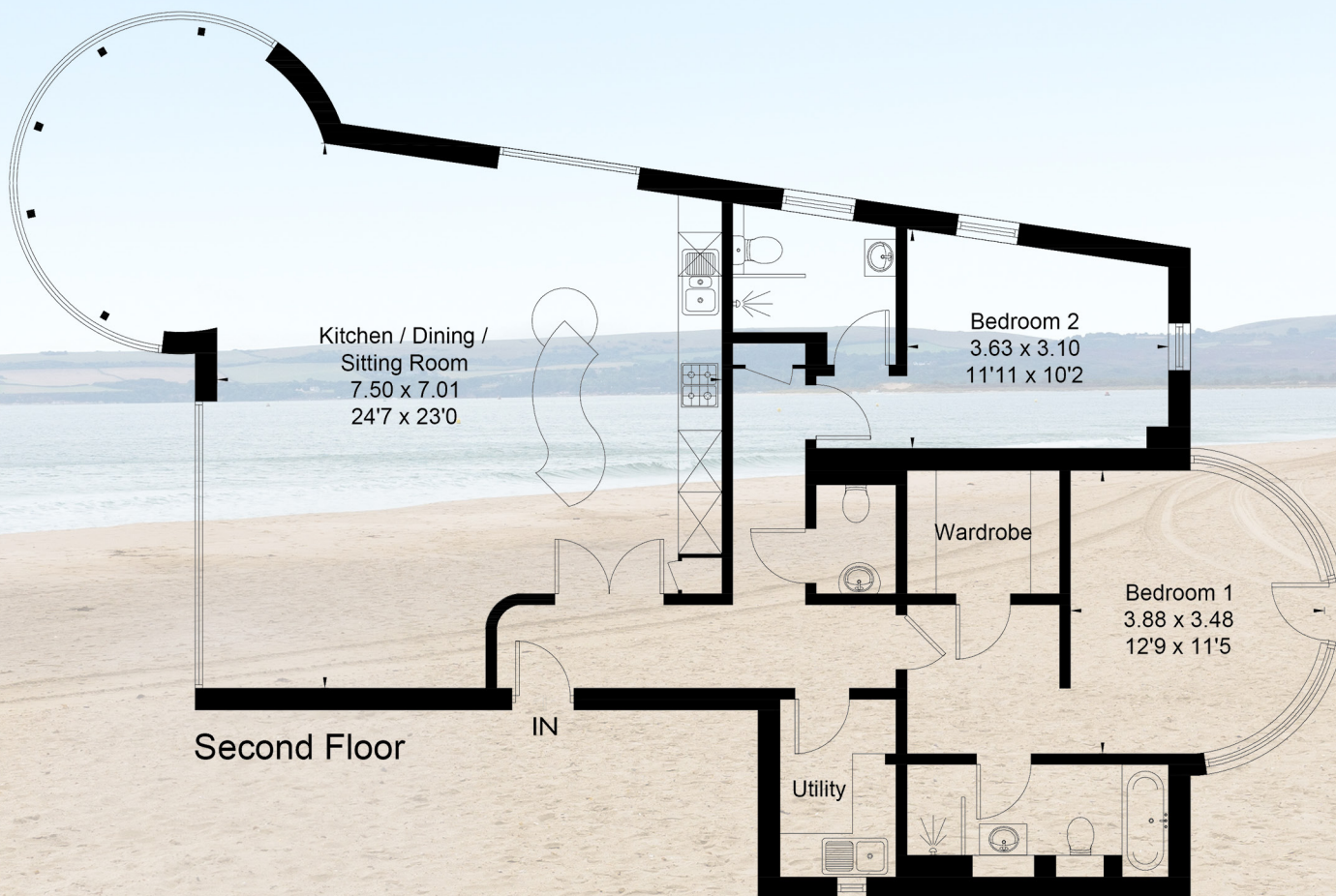

Surveyed and drawn in accordance with the International Property Measurement Standards (IPMS 2: Residential)
fourwalls-group.com 306076

Lloyds Property Group

PROPERTY NAME

Flat 2 Alcyone

Total Floor Area : 122.1 sq m / 1315 sq ft

VIEWING ARRANGEMENTS

Telephone: +44 (0)1202 708044

LOCATION

Sandbanks BH13 7PJ

Email: enquiries@lloydspropertygroup.com

Ref: 3455 AR

Illustration for identification purposes only, measurements are approximate, not to scale